

**SITE NOTICE**  
**LOCATION 1**  
 494079-E  
 822742-N

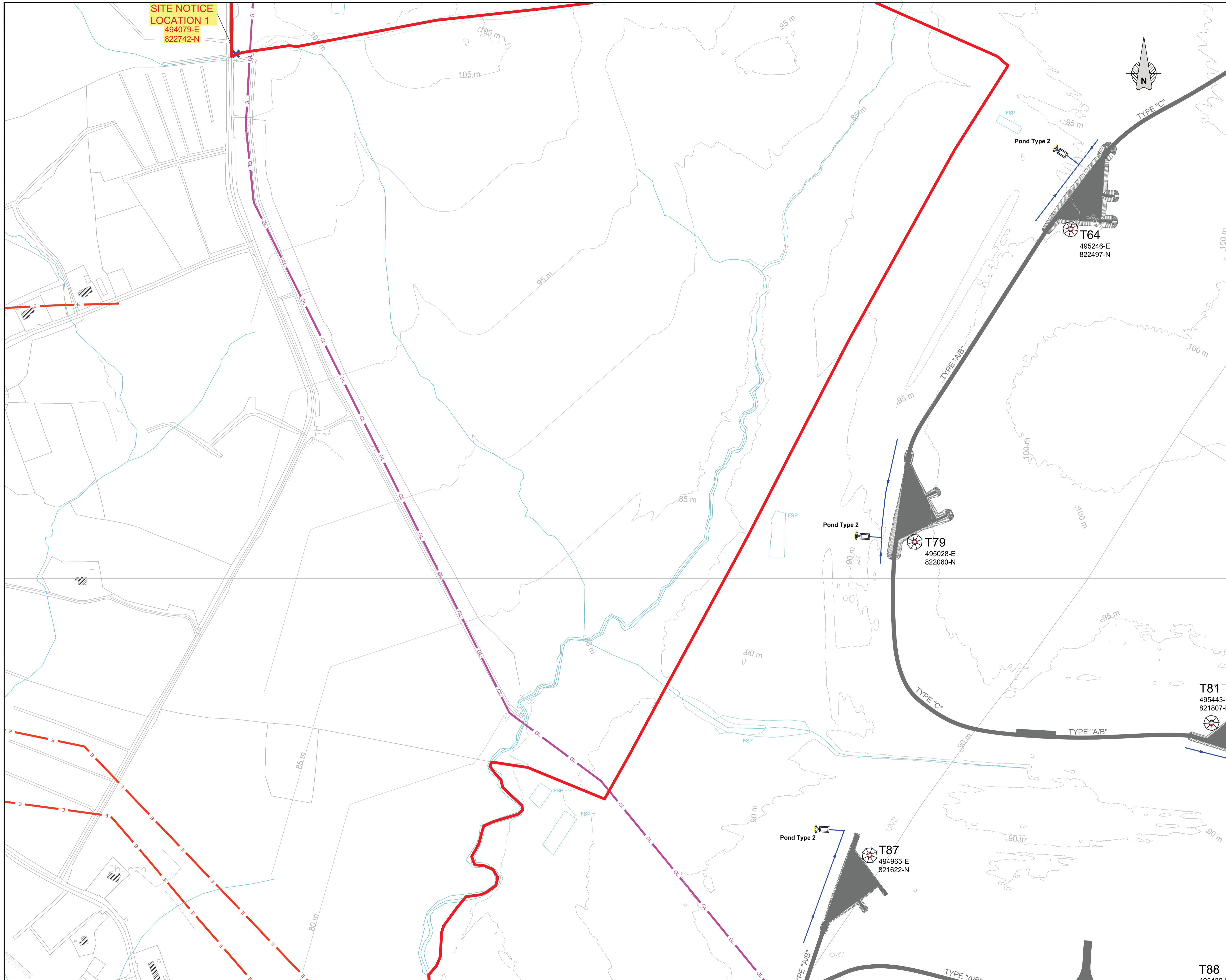

- Legend:**
- Site Boundary
  - Proposed Turbines & Hardstandings (See drawing QR320201-P-000-042 for details)
  - Proposed Access Tracks, Passing Bays, Turning Areas & Probable Track Type. (See drawings QR320201-P-000-056, QR320201-P-000-057, QR320201-P-000-072 & QR320201-P-000-073 for details)
  - Proposed Sub Stations (See drawings QR320201-P-000-043 to QR320201-P-000-050 for details)
  - Proposed Meteorological Mast & Hardstanding Area (See drawing QR320201-P-000-052 for details)
  - Proposed Borrow Pit
  - Proposed Peat Deposition Area
  - Proposed Overhead Line & Structures
  - Contours**
  - Rivers, Lakes & Pools**
  - Proposed Settlement Pond Types (See Drawings QR320201-P-000-063 & QR320201-P-000-064 for details)
  - Existing Underground Electrical Lines
  - Existing Overhead Electrical Lines
  - Existing Gas Line
  - Dwellings
  - Former Peat Operations Settling Pond
  - Forestry or Felled Areas
  - Existing Bellacorick Wind Farm Turbines

**Notes:**

- For site layout sheet locations see Sheet Index Plan
- Drawing prepared using Irish Transverse Mercator (ITM) Map Grid
- For drainage details see drawings QR320201-P-000-059 to QR320201-P-000-073
- Industrial railway shown on maps has been decommissioned
- For clarity field drains formerly used for peat operations which still exist on site are not shown

Maps shown on site layout drawings:  
 Mayo 5000 sheets 1174, 1175, 1176, 1177, 1240, 1241, 1242, 1243, 1309, 1310, 1311, 1312, 1376, 1378, 1380 & 1381  
 Copyright Ordnance Survey Ireland Licence No. 0023704-09

0	10.04.13	ISSUED FOR PLANNING	EOS	PK	JC
REV.	DATE	REVISION DESCRIPTION	DRN	VER	APP

PURPOSE OF ISSUE - PRELIMINARY UNLESS INDICATED

TENDER  CLIENT APPROVAL  CONSTRUCTION  AS-BUILT  REVISED

Client  
**OWENINNY POWER LTD.**

Project  
**WIND FARM PROJECT AT OWENINNY, BELLACORICK, Co. MAYO**

Contract

Drawing Title  
**SITE LAYOUT MAP SHEET 22 OF 39**

Production Unit  
**CIVIL, BUILDING & ENVIRONMENTAL GROUP**

**Oweninny Power Ltd**

Oweninny Power Ltd, Stephen Court, 18-21 St. Stephen's Green, Dublin 2, Ireland Tel: +353 (0)1 7038000 Fax: +353 (0) 1 7038088 Email: oweninnypower@esbi.ie Web: www.oweninnywindfarm.ie Registered Office: as above Registered in Ireland No. 503730

DRAWN	VERIFIED	APPROVED	APPRO DATE
E.OS	P.K	J.C	10.04.2013
CLIENT REF	No. of SHEETS	SIZE	REV
	1	A1	0
SCALE			1:2500

DRAWING NUMBER  
**QR320201-P-000-022**

COPYRIGHT © ESSI ENGINEERING & FACILITY MANAGEMENT LIMITED. All rights reserved. No part of this work may be modified or reproduced or copied in any form or by any means, graphic, electronic or mechanical, including photocopying, recording, taping or information-and-retrieval system, or used for any purpose other than its designated purpose, without the written permission of ESSI Engineering & Facility Management Ltd.

**While every effort has been made to ensure the accuracy of the information contained in the drawings, Oweninny Power Limited cannot be held responsible for errors or omissions.**

Ordnance Survey mapping includes watercourses and water features which have been transposed from historic 6 inch mapping and may no longer exist on the ground due to drainage over the decades associated with peat production operations.

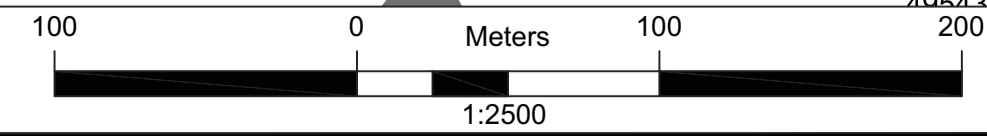

**T88**  
 495432-E  
 821807-N